

SVX10 Installation Instructions

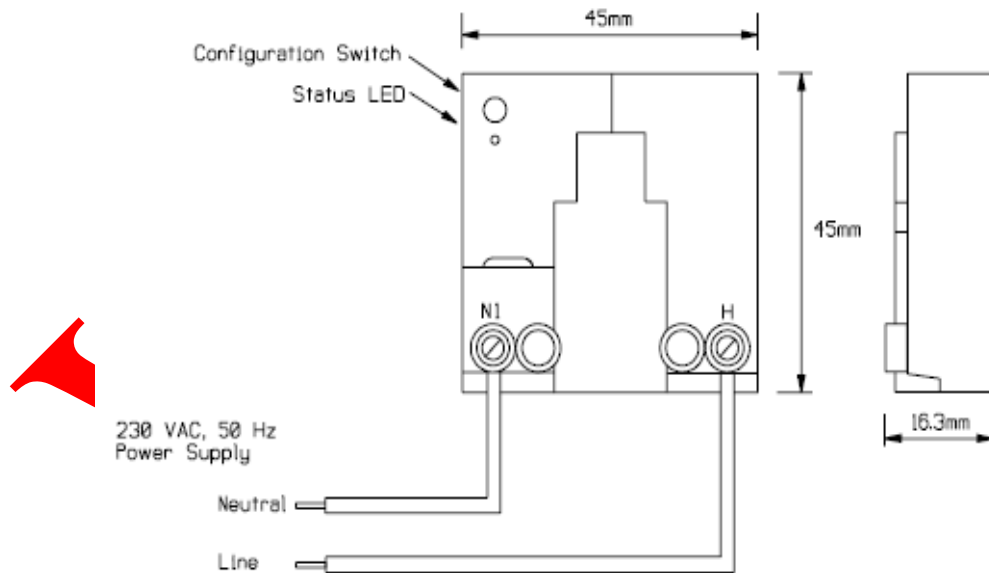

SVX10

me



SVX10 Wiring Diagram

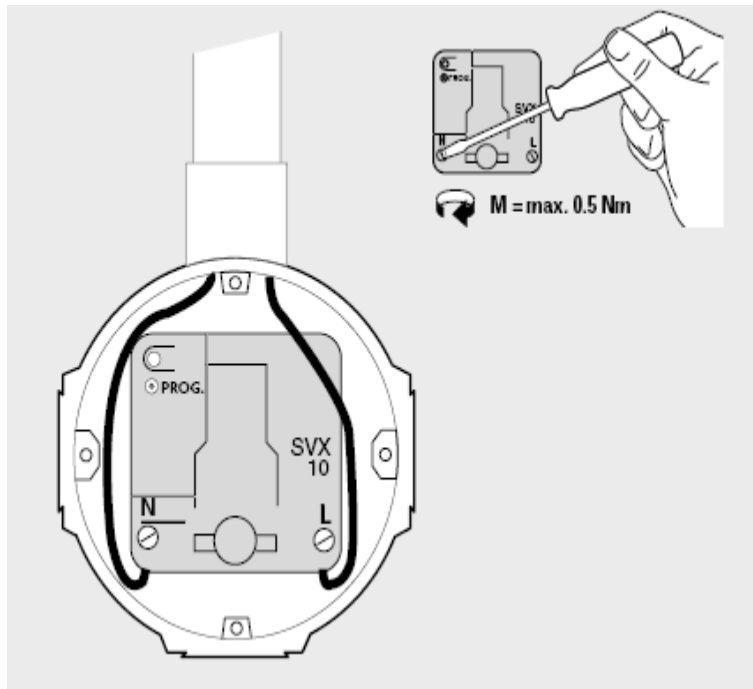

Installing & Connecting the SVX10

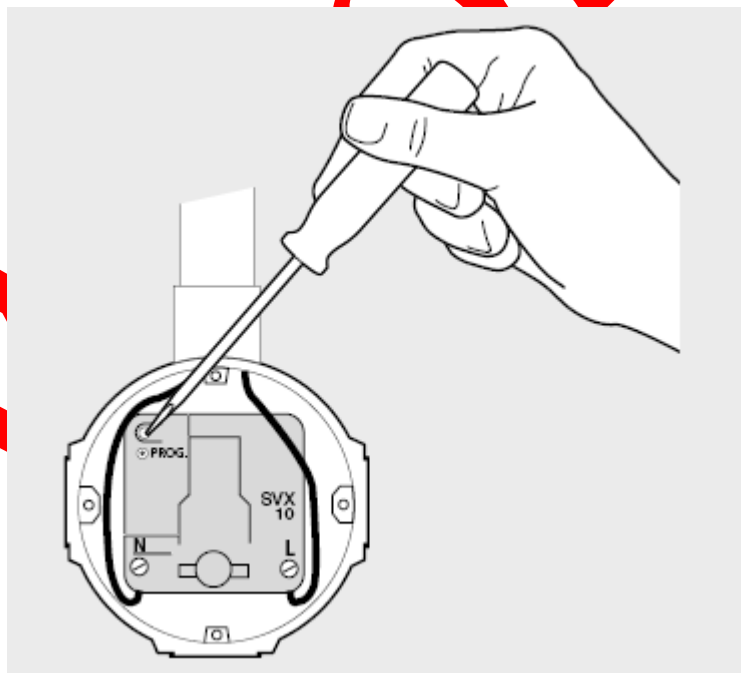

Activating & Cancelling Programming Mode

Product Description:

The SVX10 is a signal amplifier that amplifies and then transmits the signals in a single phase installation. The SVX10 is mounted in a junction box or in a parallel across the active and neutral terminals behind the light switch or power point.

Operation:

SVX10 repeats all Standard Code commands and Extended Code 1 commands. SVX10 has the ability to be configured as follows:

1. To repeat only certain letter codes
2. To ignore or repeat previously repeated signals
3. To transmit at 0° only or 0° and 30°

Factory settings are:

1. Transmits at 0°
2. Will ignore previously repeated code
3. Will repeat all letter codes

LED Operation:

When unit is powered and detects a zero crossing, the LED will illuminate.

When the unit receives a start code, the LED will turn off.

When the unit begins repeating (transmitting) the data, the LED will flicker.

The LED illuminates again, either when the SVX10 completes transmitting, or when the code it is receiving becomes corrupt.

Installation:

Mounting:

This module is small enough to be placed loose behind a European wall-outlet or wall switch in a built-in box, or a central ceiling box (see photo for typical). These boxes are normally 40 or 50 mm deep, and the size of this SVX10 module does not exceed 16.5 mm in thickness.

Power Connections:

1. Warning, shock hazard: To service the load, disconnect main power.
2. Make 230V power connection as follows:

- a) Connect the 230 VAC LINE wire to screw terminal H.
- b) Connect the 230 VAC NEUTRAL wire to screw terminal N1.

Configuring: (Restore the Power)

Defaults are as follows:

1. Ignores repeated code
2. Transmits at 00.
3. Repeats all letter codes

To enter the SVX10 configuration mode, use an electrically insulated tool to press and hold the configuration push button "ON" for just over three seconds and release. The LED should remain on. The SVX10 is now in configuration mode.

All transmissions to the device while in configuration mode must be transmitted twice. The two transmissions must be separated by at least 100 zero crossings (approximately 1 second).

1. To set the device to Ignore Repeat Repeated Code, the STATUS ON command must be transmitted twice to the device.

To set the device to Repeat Repeated Code, the STATUS OFF command must be transmitted twice to the device.

LED INDICATION will be:

Ignore Repeated Code - **Six flashes**
Repeat Repeated Code - **Five flashes**

2. To set the device to Transmit at 0° only the OFF command must be transmitted twice to the device.

To set the device to Transmit at 0° and 30° the ON command must be transmitted twice to the device.

LED INDICATION will be:

Transmit at 0° only - **Three flashes**

Transmit at 0° and 30° - **Four flashes**

3. To configure the device to repeat only certain letter codes, transmit the letter code and number code to the device twice (the number code does not matter). The letter code and number code can be transmitted along with the ON or OFF command code or by itself.

For example:

A1A1 A1A1 can be transmitted to the device to set it to only repeat letter code A

Or

A1A1 AONAON A1A1 AONAON can be transmitted to achieve the same results.

The two transmissions must be separated by at least 100 zero crossings (1 second), so that the ON or OFF command is ignored.

If after setting the device to repeat only certain letter codes, it is desired to set the device back to repeating all letter codes, the ALL LIGHTS ON command should be transmitted twice to the device.

There are two additional indications that the user may see. One, if the user attempts to configure a letter code that has already been configured and two, if the user has entered 15 distinct letter codes already.

LED INDICATION will be:

- a) Repeat Only Certain Letter Codes - **One flash**
- b) Letter Code Already Configured - **Two flashes**
- c) No More Letter Codes can be Configured - **Ten flashes**
- d) Reset (Repeat All letter codes) - **Seven flashes**

The user may exit the configure mode by pressing the configure push button once or wait for 60 seconds at which point the SVX10 will exit configuration mode.

CHECKOUT

1. Test Operation:
Using a controller, transmit appropriate commands to ensure proper operation and correct interference filtering. This product is compatible with standard X10 systems.
2. If at any time the STATUS LED flashes off and on quickly without stopping, reset the SVX10 by powering the unit down and back up. If the error returns and cannot be cleared through a reset, the unit could need repair or replacement.